



FRONT ELEVATION
SCALE 1:100



REAR ELEVATION
SCALE 1:100

NOTES ON FINISHES:	
ROOF:	TO BE FINISHED IN SLATE OR CONCRETE ROOF TILES IN SELECTED COLOUR OR SIMILAR APPROVED
WALLS:	SELECTED CLAY BRICKWORK OR METAL CLADDING WHERE INDICATED OTHERWISE SELECTED SELF-COLOURED RENDER
JOINERY:	ALL WINDOWS AND DOORS, FRAMES AND LEAFS TO BE ALUMINIUM POWDER COATED TO APPROVED COLOUR OR UPVC OR PAINTED TIMBER TO APPROVED COLOUR. OBSCURE GLAZING WHERE INDICATED TO SENSITIVE WINDOWS
RAINWATER GOODS:	GUTTERS, DOWNPIPES AND FIXINGS TO BE uPVC OR ALUMINIUM POWDER COATED TO SELECTED COLOUR TO MATCH ROOF SLATES.

Notes

Refer to Architects Site Plan Drawing for North orientation of each units and handing.

Levels on unit type drawings are given relative to 0.00 FFL of the unit type. Refer to Architects Site Plan Drawing for specific FFLs of each unit relative to Malin Head datum level.

Do not scale from this drawing.
Use figured dimensions only.
All errors and omissions to be reported to the Architect.
This drawing is to be read in conjunction with relevant consultant's drawings.
This drawing is for planning purposes only and not for construction.
This drawing or design may not be reproduced without permission.

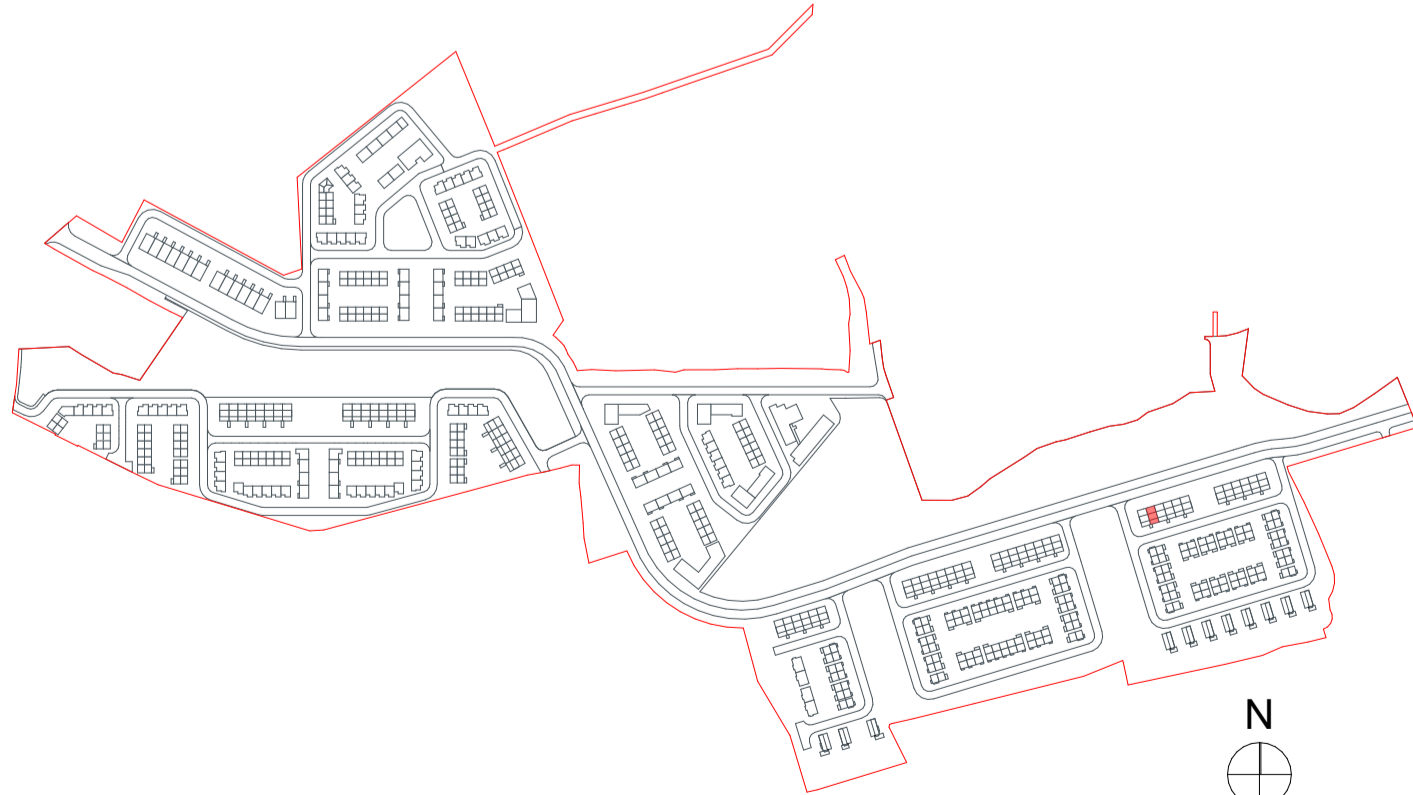

DAVEY+SMITH ARCHITECTS	Planning Application	DAVEY+SMITH ARCHITECTS
DAVEY+SMITH ARCHITECTS 13 SEAPONT BUILDING, 44/45 CLONTARF ROAD, CLONTARF, DUBLIN 3 PH: 01 2447638 EMAIL: info@davey-smith.com WEB: www.davey-smith.com	Layout ID: 2205-Oldcourt-PLA-DP A06 PV	Scale: As Shown (@A1)
Project: LRD-Development at Oldcourt - Duplex Type A	Job No: 2205	Series: PLANNING
Drawing Name: Proposed Front and Rear Elevations	Date: 03/09/2024	Status: Planning